

# Double AccuSeal®



Dual-fastener exhaust clamp makes a secure connection.

For Slotted Lap Style Joint Connections | Superior Clamp Load Capacity | Aluminized, 409 or 430 Stainless Steels | Diameter Range 4" – 5 1/4"

## DOUBLE ACCUSEAL

- Aluminized, 409 or 430 Stainless Steels
- Corrosion-Resistant Hardware
- Reaction Block Serves as Connection Point

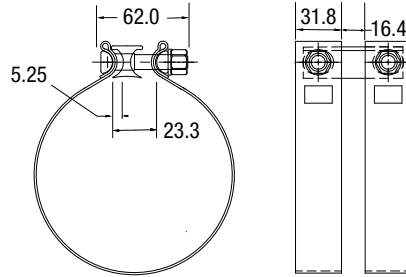

Units: mm



DOUBLE ACCUSEAL		Band Material		Nominal Joint Diameter	
Brand PN	Global PN	Left Band	Right Band	inches	mm
13-0005	0369 0001 072	Aluminized Steel	Aluminized Steel	4	101.6
10-0319	0369 0001 326	Aluminized Steel	430 Stainless Steel	5	127.0
13-0008	0369 0011 072	Aluminized Steel	430 Stainless Steel	5	127.0
13-0001	0369 0031 326	Aluminized Steel	430 Stainless Steel	5	127.0
13-0007	0369 0051 326	Aluminized Steel	Aluminized Steel	5	127.0
13-0011	0369 0061 326	430 Stainless Steel	430 Stainless Steel	5	127.0
13-0012	0369 0071 326	409 Stainless Steel	430 Stainless Steel	5 1/8, 5 1/4	129.5, 132.0
13-0013	0369 0091 326	430 Stainless Steel	409 Stainless Steel	5 1/4, 5 1/8	132.0, 129.5

Note: AccuSeal® connections require 'sized' and slotted pipe. Torca recommends the Torca Seal-Slot design.

Note: Additional sizes are available to meet specific application requirements.

