

## E-Series V-Clamp



Economical coupling with continuously formed metal band for ducting, air, and exhaust applications.

**Weld-Free Construction** | **Continuously Formed Band Having Two 180° V-Inserts** | **Diameter Range 2.81" – 21.25"**

### 902 E-SERIES V-CLAMP

1/4", 5/16" Fasteners  
300-Series SS Insert  
40° Insert Angle

### 904 E-SERIES V-CLAMP

1/4", 5/16" Fasteners  
CRS Plated Insert  
40° Insert Angle

### 2275 E-SERIES V-CLAMP

1/4", 5/16" Fasteners  
50 in.-lb. Tightening Torque  
90° Insert Angle

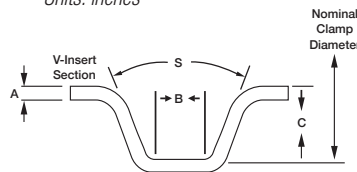
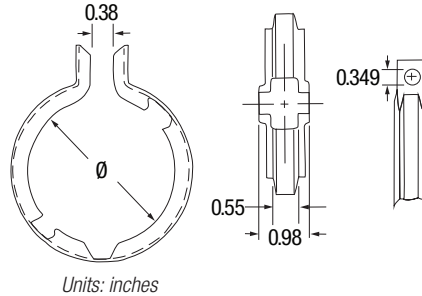

| 902 E-SERIES V-CLAMP |               | Nominal Diameter (Ø) |       | Installation Torque | Insert Angle (S) | Insert Thickness (A) |      | Insert Apex Width (B) |      | Insert Depth (C) |      |
|----------------------|---------------|----------------------|-------|---------------------|------------------|----------------------|------|-----------------------|------|------------------|------|
| Brand PN             | Global PN     | in                   | mm    |                     |                  | in                   | mm   | in                    | mm   | in               | mm   |
| 000902-281           | 0373 0701 071 | 2.81                 | 71.4  | 35 in.-lb.          | 40°              | 0.060                | 1.52 | 0.207                 | 5.26 | 0.281            | 7.14 |
| 000902-334           | 0373 0702 085 | 3.34                 | 84.8  | 35 in.-lb.          | 40°              | 0.060                | 1.52 | 0.207                 | 5.26 | 0.281            | 7.14 |
| 000902-384           | 0373 0702 098 | 3.84                 | 97.5  | 35 in.-lb.          | 40°              | 0.060                | 1.52 | 0.207                 | 5.26 | 0.281            | 7.14 |
| 000902-434           | 0373 0703 110 | 4.34                 | 110.2 | 35 in.-lb.          | 40°              | 0.060                | 1.52 | 0.207                 | 5.26 | 0.281            | 7.14 |
| 000902-484           | 0373 0701 123 | 4.84                 | 122.9 | 35 in.-lb.          | 40°              | 0.060                | 1.52 | 0.207                 | 5.26 | 0.281            | 7.14 |
| 000902-534           | 0373 0701 136 | 5.34                 | 135.6 | 35 in.-lb.          | 40°              | 0.060                | 1.52 | 0.207                 | 5.26 | 0.281            | 7.14 |
| 000902-584           | 0373 0701 148 | 5.84                 | 148.3 | 35 in.-lb.          | 40°              | 0.060                | 1.52 | 0.207                 | 5.26 | 0.281            | 7.14 |
| 000902-634           | 0373 0701 161 | 6.34                 | 161.0 | 35 in.-lb.          | 40°              | 0.060                | 1.52 | 0.207                 | 5.26 | 0.281            | 7.14 |
| 000902-684           | 0373 0701 174 | 6.84                 | 173.7 | 35 in.-lb.          | 40°              | 0.060                | 1.52 | 0.207                 | 5.26 | 0.281            | 7.14 |

| 904 E-SERIES V-CLAMP |               | Nominal Diameter (Ø) |       | Installation Torque | Insert Angle (S) | Insert Thickness (A) |      | Insert Apex Width (B) |      | Insert Depth (C) |      |
|----------------------|---------------|----------------------|-------|---------------------|------------------|----------------------|------|-----------------------|------|------------------|------|
| Brand PN             | Global PN     | in                   | mm    |                     |                  | in                   | mm   | in                    | mm   | in               | mm   |
| 000904-281           | 0373 0702 071 | 2.81                 | 71.4  | 35 in.-lb.          | 40°              | 0.060                | 1.52 | 0.207                 | 5.25 | 0.281            | 7.13 |
| 000904-334           | 0373 0703 085 | 3.34                 | 84.8  | 35 in.-lb.          | 40°              | 0.060                | 1.52 | 0.207                 | 5.25 | 0.281            | 7.13 |
| 000904-384           | 0373 0703 098 | 3.84                 | 97.5  | 35 in.-lb.          | 40°              | 0.060                | 1.52 | 0.207                 | 5.25 | 0.281            | 7.13 |
| 000904-434           | 0373 0704 110 | 4.34                 | 110.2 | 35 in.-lb.          | 40°              | 0.060                | 1.52 | 0.207                 | 5.25 | 0.281            | 7.13 |
| 000904-484           | 0373 0702 123 | 4.84                 | 122.9 | 35 in.-lb.          | 40°              | 0.060                | 1.52 | 0.207                 | 5.25 | 0.281            | 7.13 |
| 000904-534           | 0373 0702 136 | 5.34                 | 135.6 | 35 in.-lb.          | 40°              | 0.060                | 1.52 | 0.207                 | 5.25 | 0.281            | 7.13 |
| 000904-584           | 0373 0702 148 | 5.84                 | 148.3 | 35 in.-lb.          | 40°              | 0.060                | 1.52 | 0.207                 | 5.25 | 0.281            | 7.13 |
| 000904-634           | 0373 0702 161 | 6.34                 | 161.0 | 35 in.-lb.          | 40°              | 0.060                | 1.52 | 0.207                 | 5.25 | 0.281            | 7.13 |
| 000904-684           | 0373 0702 174 | 6.84                 | 173.7 | 35 in.-lb.          | 40°              | 0.060                | 1.52 | 0.207                 | 5.25 | 0.281            | 7.13 |

| 2275 E-SERIES V-CLAMP |               | Nominal Diameter (Ø) |       | Installation Torque | Insert Angle (S) | Insert Thickness (A) |       | Insert Apex Width (B) |      | Insert Depth (C) |             |
|-----------------------|---------------|----------------------|-------|---------------------|------------------|----------------------|-------|-----------------------|------|------------------|-------------|
| Brand PN              | Global PN     | in                   | mm    |                     |                  | in                   | mm    | in                    | mm   | in               | mm          |
| 002275-013            | 0373 0801 365 | 14.38                | 365.1 | 50 in.-lb.          | 90°              | 0.075                | 1.905 | 0.375                 | 9.52 | 0.410/0.440      | 10.40/11.10 |
| 002275-014            | 0373 0801 384 | 15.13                | 384.2 | 50 in.-lb.          | 90°              | 0.075                | 1.905 | 0.375                 | 9.52 | 0.410/0.440      | 10.40/11.10 |
| 002275-016            | 0373 0801 435 | 17.13                | 435.0 | 50 in.-lb.          | 90°              | 0.075                | 1.905 | 0.375                 | 9.52 | 0.410/0.440      | 10.40/11.10 |
| 002275-018            | 0373 0801 489 | 19.25                | 489.0 | 50 in.-lb.          | 90°              | 0.075                | 1.905 | 0.375                 | 9.52 | 0.410/0.440      | 10.40/11.10 |
| 002275-020            | 0373 0801 540 | 21.25                | 539.8 | 50 in.-lb.          | 90°              | 0.075                | 1.905 | 0.375                 | 9.52 | 0.410/0.440      | 10.40/11.10 |

Note: Call for a complete list of sizes and materials.